



Reservation Woods Preservation Project Monitoring Report

Project Operator Name: Kendall County Forest Preserve District

Project Name: Reservation Woods

Project Location: Kendall County, IL

Deadline to Submit to CFC: January 17 2026

1. Has the contact info for the Project Operator changed? If so, please provide new contact info.

Stefanie Wiencke, Environmental Education and Public Outreach Division Manager, 110 W Madison Street, Yorkville, IL, 60560, swiencke@kendallcountyil.gov

2. Have there been changes in land ownership of the Project Area?

No

3. Have there been any changes in the Project Design?

No

4. Have there been any changes in the implementation or management of the Project?

No

5. Have there been any significant tree or canopy losses? Are there any areas of canopy change, growth or loss, that are important to note? (Provide any Google Earth Imaging or photos to show no significant changes).

No – please see Kendall County GIS Image taken 2025 below

6. Please estimate the number of acres of significant soil disturbance since the previous monitoring report. Examples include plowing and removal of topsoil. For the purposes of these reports, areas of soil exposed by trees tipping over are not counted as areas of significant soil disturbance.

N/A

7. Any other significant elements to report?

No

8. Please provide a photo of staff in, or the public using, the forest. (This is optional.)

Signed on January 11 in 2026, by Stefanie Wiencke, for the Kendall County Forest Preserve District.



Signature

____ Stefanie Wiencke _____
Printed Name

____ 630-229-4828 _____
Phone

swiencke@kendallcountyil.gov

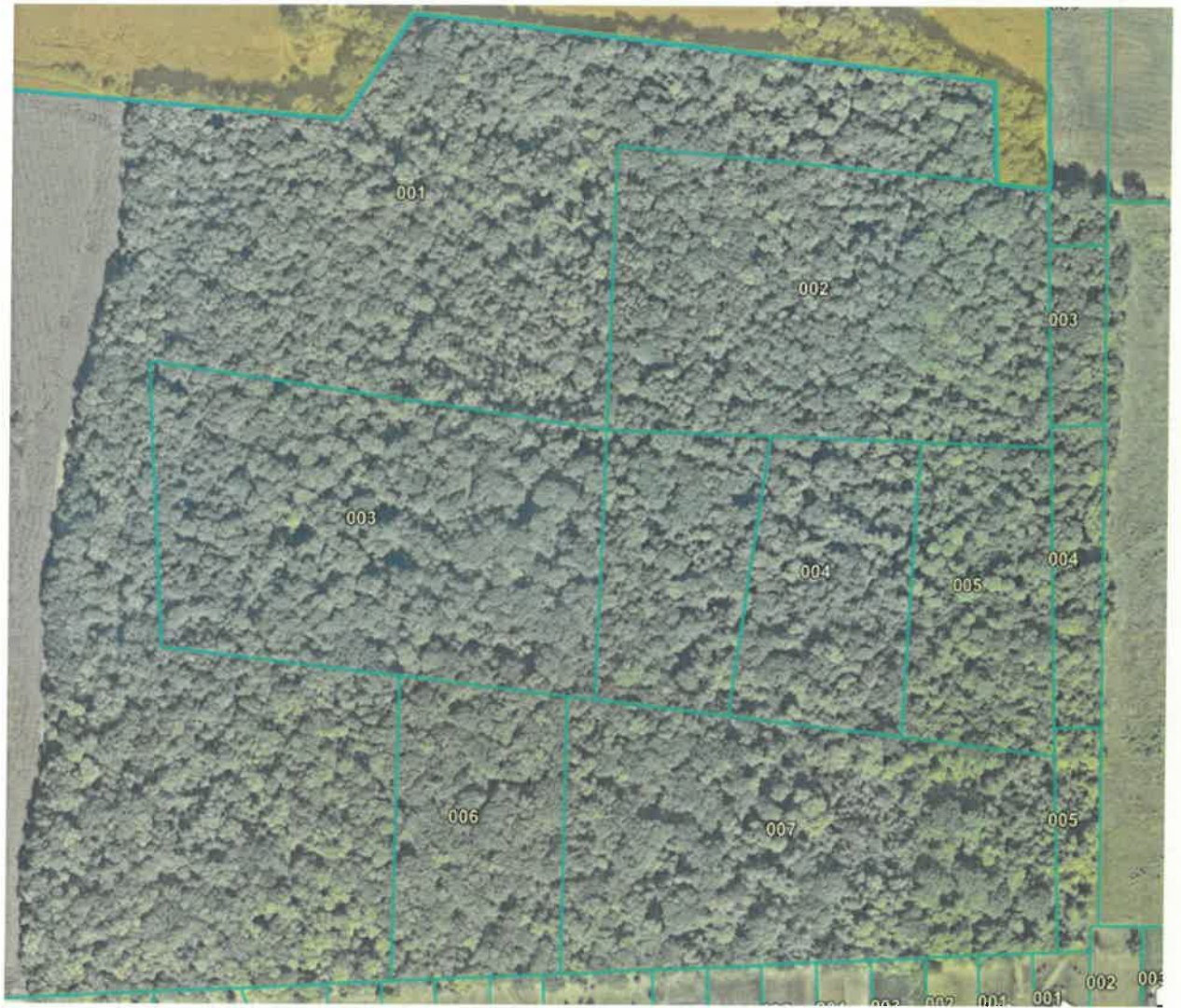
Email



3. Project Location

The two 5-acre parcels acquired are located in the Reservation Woods Acquisition Area in unincorporated Kendall County, Illinois (See attached "Exhibit A"). The parcels were purchased by the Kendall County Forest Preserve District in 2021, a conservation-focused county municipal government agency. The parcels are located within the headwaters of Morgan Creek, a tributary of the Fox River.

- 1) Jaross Parcel: 4.7899 acres – Lot 50

PIN# 05-01-400-004

Description: Sub Lot 50 of Section 1, Township 36 North, Range 7 east of the third principal meridian according to the plat of known as Assessor's Plat of said section, recorded in the Recorder's Office of Kendall County, Illinois, in Plat Book 3, Page 58, situated in the Township of Kendall, Kendall County, Illinois.

- 2) Parish Parcel: 5.2970 acres – Lot 51

PIN# 05-01-400-005

Description: Sub Lot 51 of the Southeast Quarter of Section 1, Township 36 North, Range 7 East of the Third Principal Meridian, as shown in Plat Book 2 at Page 1, all in Kendall Township, Kendall County, Illinois.